



4 Pavilion Close

Stanningley, Leeds, West Yorkshire, LS28 6NL

£125,000



Property Summary

HOP are excited to present this fantastic, two bedroom ground floor apartment situated in the popular area of Stanningley. Ideally situated in close reach of transport links and local amenities, this lovely property would be perfect for first time buyers or investors alike. Offered chain free this property briefly comprises; spacious living room and fully fitted kitchen, two double bedrooms with en-suite to master and also a main family bathroom. The inner hallway offer storage cupboards. Externally there is allocated parking and well maintained clean communal areas

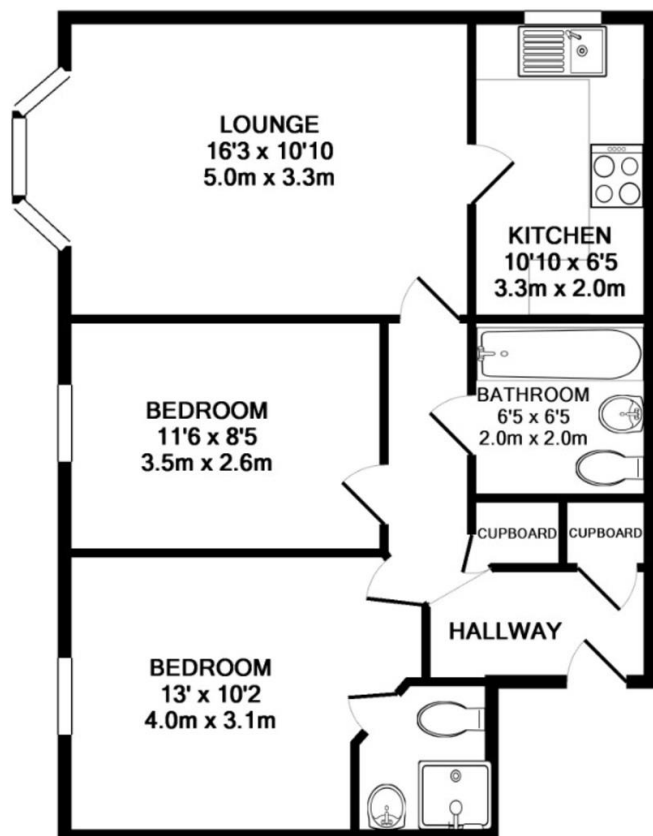

Energy Efficiency Rating		Current	Potential
Very energy efficient - lower running costs			
(92-100)	A		
(81-91)	B		
(69-80)	C		
(55-68)	D		71
(39-54)	E	56	
(21-38)	F		
(1-20)	G		
Not energy efficient - higher running costs			
England, Scotland & Wales		EU Directive 2002/91/EC	

- Two Bedroom Apartment
- Master With En-suite
- Allocated Parking
- Chain Free
- Excellent Commuter Location
- Long Lease Length
- Ideal First Time Buyer Home
- Great Investment
- Well Presented
-

Agents Note: Whilst every care has been taken to prepare these sales particulars, they are for guidance purposes only. All measurements are approximate are for general guidance purposes only and whilst every care has been taken to ensure their accuracy, they should not be relied upon and potential buyers are advised to recheck the measurements