

Head Office:
Dixon Kelley Estate Agents
1 Penn Court
Station Road, West Moors
Dorset. BH22 0JJ

Telephone: 01202 877511

DORSET PARK HOMES

DRAFT

www.dorsetparkhomes.com

32 Stour Park, New Road, Bournemouth, Dorset. BH10 7DE



Spacious Park Home with Private Garden

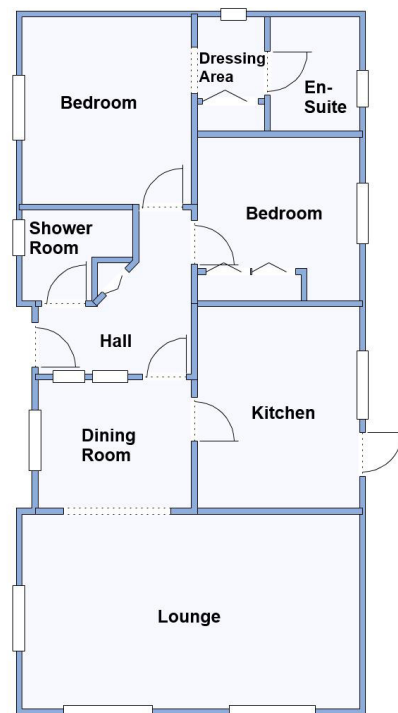

This drawing has been prepared for diagrammatic purpose only. Not to scale

2 Bedroom Park Home approx 40' x 20'

Accommodation & approximate room dimensions:

- Omar 'Sheringham' circa 1996
- Entrance Hall: Cloaks cupboard. Hatch to roof.
- Lounge: approx 19'3" x 11'. A large bright room with 2 bay windows. Feature fireplace.
- Dining Area: approx 8'9" x 7'4"
- Kitchen: approx 11'6" x 9'2". Range of base & wall units. Built-in oven, gas hob & cooker hood. Space for tall fridge/freezer & washing machine. Cupboard housing Condensing Boiler installed 2022. Airing cupboard. Door to garden.
- Bedroom 1: approx 10'8" x 9'4" Plus Dressing Area with fitted wardrobe.
- En-Suite Bathroom: Panelled bath, Pedestal wash basin & WC.
- Bedroom 2: approx 9'4" x 9'3". Fitted wardrobe.
- Shower Room: Shower cubicle. Wash basin & WC.
- Gas Central Heating & PVCu Double-Glazing
- Parking on Plot
- Private Garden with patio & lawn, sunny aspect. Metal Shed
- Age restriction 60+. No Pets
- Well maintained Residential Park close to amenities & with easy access to Bournemouth & Poole.

Good location close to amenities



Kitchen



Lounge



Dining Area



Sunny Private Garden

Price £160,000

VIEWING STRICTLY BY APPOINTMENT WITH THE VENDOR'S AGENT Dorset Park Homes 01202 877511

IMPORTANT NOTE: These particulars are believed to be correct but their accuracy is not guaranteed. They do not form part of any contract. Nothing in these particulars shall be deemed to be a statement that the property is in good structural condition or otherwise, nor that any of the services, appliances, equipment or facilities are in good working order or have been tested. Purchasers should satisfy themselves on such matters prior to purchase Ref.W04919

Pitch Fee: Approx £196.65 per month plus £9 Water per month
Subject to Annual Review
Council Tax Band: 'A' Tenure: 1983 Mobile Homes Act Agreement

The recommended specialist in Park Home sales
Proprietor: Simon Dixon

