



Crusader Road, Hedge End, Southampton **£140,000**







Crusader Road, Hedge End, Southampton

£140,000



EPC GRADE D
For full EPC please contact the branch

Property Description

Situated in the older part of Hedge End, this one bedroom ground floor maisonette is a fantastic little buy. Off the main road and not over looked from behind, there is a real sense of a seclusion. The good sized lounge/ dining room is the hub of this home leading to the galley kitchen, bathroom and the master bedroom. The main focus point of this home is the private rear garden which is accessed from the kitchen. There is plenty of room for those summer BBQ's and is a lovely addition to extend your living accommodation which is lost on most flats or maisonettes. This home also comes with one allocated parking space which can be found through the rear gate from the garden. EPC grade D. A full copy of the EPC is available on request. For room dimensions please visit the property on your-move.co.uk.

Our View

What a great starter home! This ground floor property is ideal for a first time buyers looking to get on the property market. If you are getting tired of seeing flats with no outside space, then come and have a look at this!

Location

This part of Hedge End is serviced from plenty of local amenities including grocery shops and a hairdressers. A short walk to the main village centre which has everything to offer from larger grocery shops, banks and travel agents. A stones throw away are walks to Manor Farm Country Park.

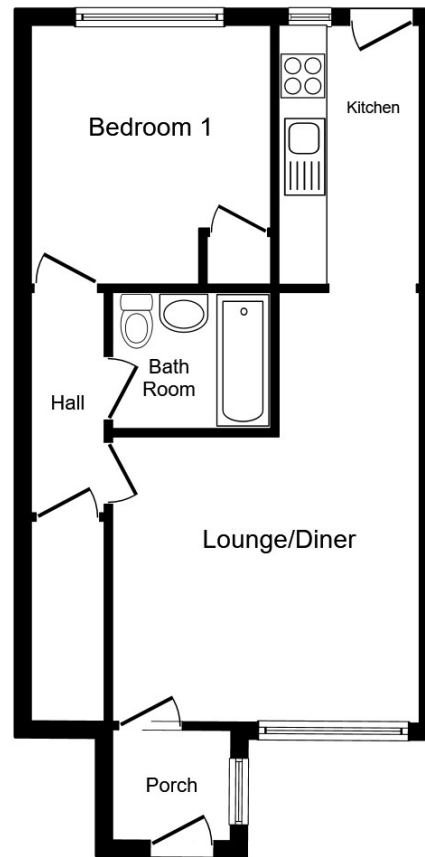

Floor Plan

This plan is for illustration purposes only and may not be representative of the property. Plan not to scale.

Powered by audioagent.com

IMPORTANT NOTE TO PURCHASERS: We endeavour to make our sales particulars accurate and reliable, however, they do not constitute or form part of an offer or any contract and none is to be relied upon as statements of representation or fact. The services, systems and appliances listed in this specification have not been tested by us and no guarantee as to their operating ability or efficiency is given. All measurements have been taken as guide to prospective buyers only, and are not precise. Floor plans where included are not to scale and accuracy is not guaranteed. If you require clarification or further information on any points, please contact us, especially if you are travelling some distance to view. Fixtures and fittings other than those mentioned are to be agreed with the seller.

Your Move is a trading name of your-move.co.uk, registered in England at Newcastle House, Albany Court, Newcastle Business Park, Newcastle upon Tyne NE4 7YB (number 01864469).

*Calls may be recorded and/or monitored for training and/or security purposes.

7 Stirling House, St Johns Road, Hedge End, SO30
4AA

01489 789292 * HedgeEnd@your-move.co.uk

