



Nethercott Court, Tyldesley, Manchester **£100,000**





YOUR MOVE





Nethercott Court, Tyldesley, Manchester

£100,000

Property Description

This BEAUTIFULLY PRESENTED, modern and welcoming home, is nestled in a QUIET CUL DE SAC, close to good schools and the centre of Tyldesley. Entered via a homely hallway, the property benefits from a private and SPACIOUS living area with french doors out to the rear garden, which is not overlooked. Upstairs, the second of the two generously sized bedrooms benefits from this open aspect to the rear, facing out only onto fields adjacent to the school. Decorated to a high standard throughout, viewing is highly recommended to appreciate both the pleasant location and the standard of accommodation on offer. A copy of the EPC will be available on request. EPC Grade D.

Our View

Ideal for first time buyers, a small family or those downsizing, this property is in move in condition and a real credit to the current owners. Whilst it benefits from the privacy and peace and quiet of a cul de sac, it is also within walking distance of Tyldesley town centre.

Location

Located on a small estate just off Squires lane, the property is within walking distance of well esteemed Fred Longworth High School.



EPC Grade D

For full EPC please contact the branch

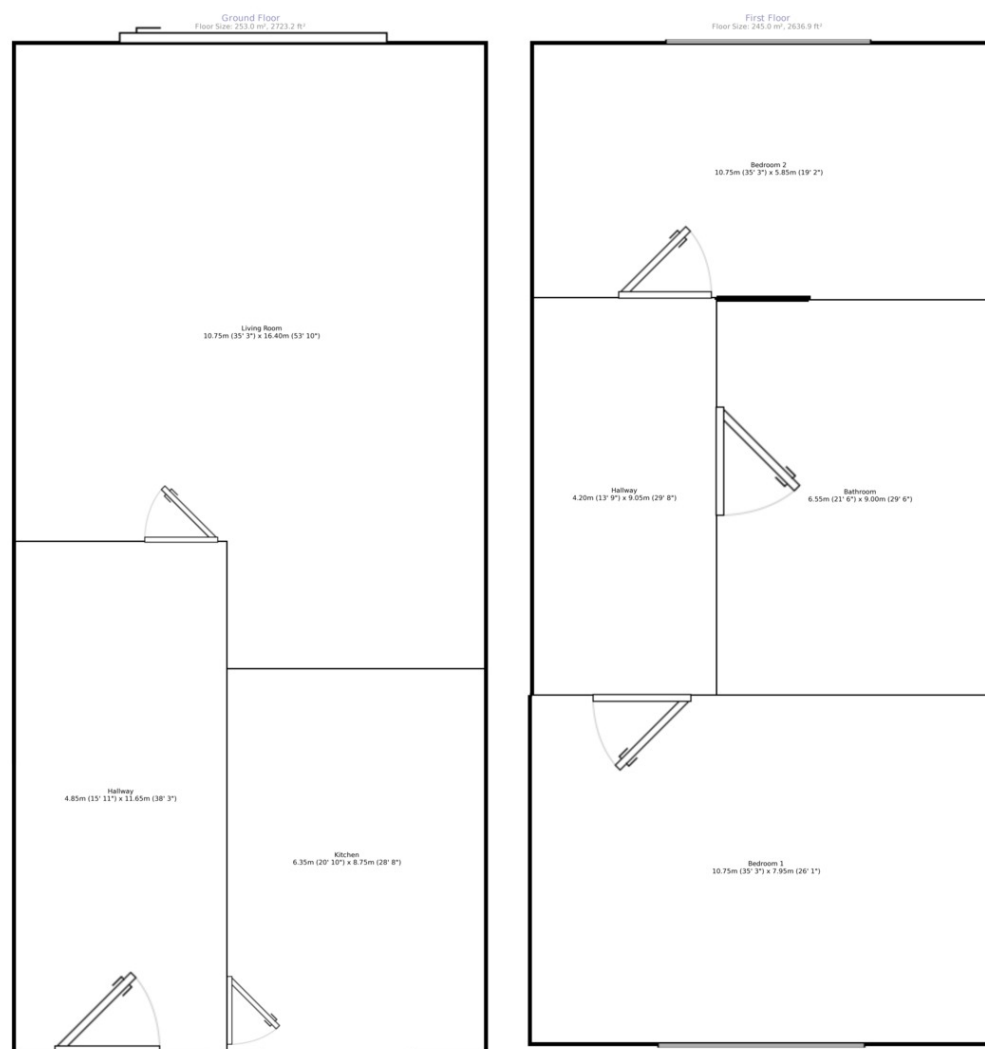

Measurements are approximate. Not to scale. For illustrative purposes only.

IMPORTANT NOTE TO PURCHASERS: We endeavour to make our sales particulars accurate and reliable, however, they do not constitute or form part of an offer or any contract and none is to be relied upon as statements of representation or fact. The services, systems and appliances listed in this specification have not been tested by us and no guarantee as to their operating ability or efficiency is given. All measurements have been taken as guide to prospective buyers only, and are not precise. Floor plans where included are not to scale and accuracy is not guaranteed. If you require clarification or further information on any points, please contact us, especially if you are travelling some distance to view. Fixtures and fittings other than those mentioned are to be agreed with the seller.

Your Move is a trading name of your-move.co.uk, registered in England at Newcastle House, Albany Court, Newcastle Business Park, Newcastle upon Tyne NE4 7YB (number 01864469).

*Calls may be recorded and/or monitored for training and/or security purposes.

Tyldesley House, Unit 4 Elliott Street, Tyldesley,
Manchester, M29 8DS

01942 894500 * Astley@your-move.co.uk

