



Kenton Lane

Harrow, HA3 8TL

£750,000

A deceptively spacious 4 bedroom semi detached house providing 2 bathrooms, 2 reception rooms, large kitchen and a 21' x 12.4 brick outbuilding located to the rear of the 80' west facing rear garden. No Upper Chain. Located close to Kenton Library, Priestmead and Park High schools, rail links, bus routes, Harrow Leisure Centre and Kenton Recreation Ground.



GROUND FLOOR
1253 sq.ft. (116.5 sq.m.) approx.

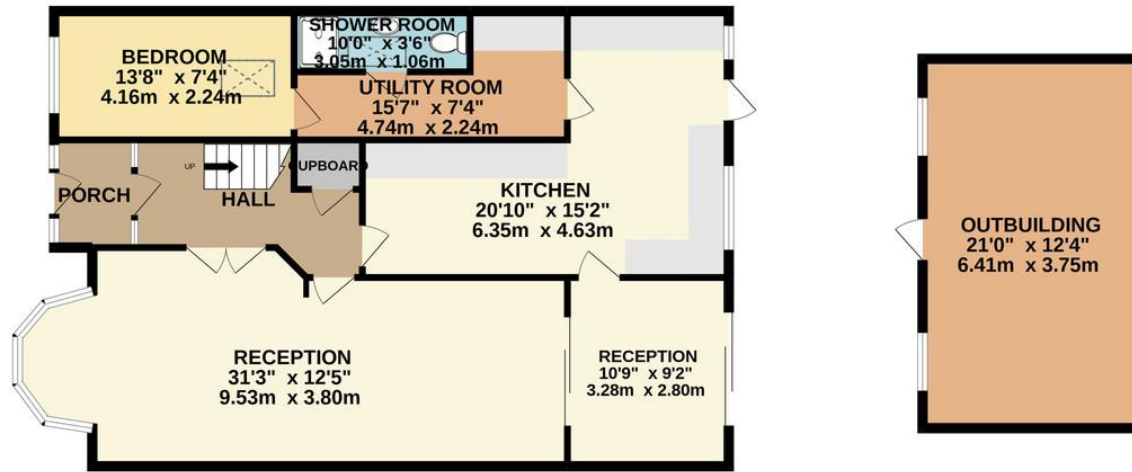

1ST FLOOR
534 sq.ft. (49.6 sq.m.) approx.

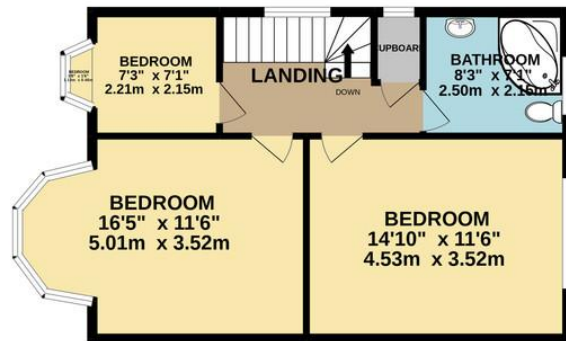

EPC Rating: to be confirmed

TOTAL FLOOR AREA: 1787 sq.ft. (166.0 sq.m.) approx.

Whilst every attempt has been made to ensure the accuracy of the floorplan contained here, measurements of doors, windows, rooms and any other items are approximate and no responsibility is taken for any error, omission or mis-statement. This plan is for illustrative purposes only and should be used as such by any prospective purchaser. The services, systems and appliances shown have not been tested and no guarantee as to their operability or efficiency can be given.
Made with Metropix ©2022

Belmont Circle Office
506 Kenton Lane
Harrow
Middlesex
HA3 8RD

www.blacklarsestateagents.co.uk
0208 907 7701
sales@blacklarsestates.co.uk

Agents Note: Whilst every care has been taken to prepare these particulars, they are for guidance purposes only. All measurements are approximate and for general guidance purposes only and whilst every care has been taken to ensure their accuracy, they should not be relied upon and potential buyers/tenants are advised to recheck the measurements