



# Property Summary

Attractive three bedroom town house available for sale in Aylestone. Comprising entrance lobby, spacious living room, kitchen /diner, conservatory downstairs, together with three bedrooms and bathroom upstairs, this property is in excellent condition throughout. Also boasting a quiet but well proportioned garden to the rear, the property sits in an enviable position for local schools and amenities and would make an excellent first time buy or investment.



GROUND FLOOR  
472 sq.ft. (43.9 sq.m.) approx.



1ST FLOOR  
407 sq.ft. (37.8 sq.m.) approx.

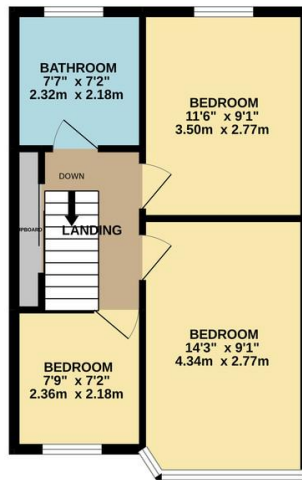
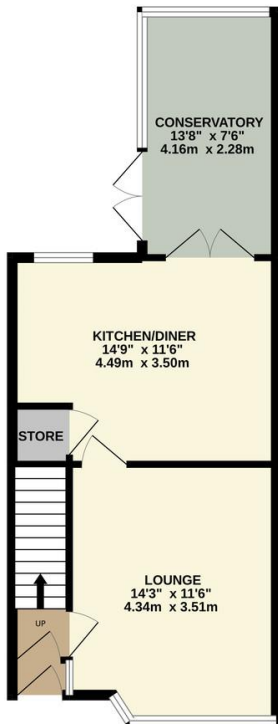

TOTAL FLOOR AREA : 879 sq.ft. (81.7 sq.m.) approx.

Whilst every effort has been made to ensure the accuracy of the floorplan contained herein, measurements of doors, windows, rooms and any other items are approximate and no responsibility is taken for any error, omission or mis-statement. This plan is for illustrative purposes only and should be used as such by any prospective purchaser. The services, systems and appliances shown have not been tested and no guarantee

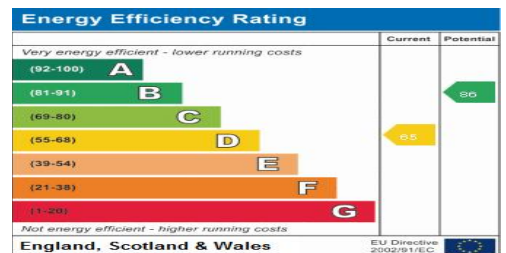

Address:  
Middlesex Road  
Reference:  
Middlesex Road

- Three Bedrooms
- Town House
- Excellent Condition Throughout
- Kitchen Diner
- Spacious Living Room
- Brick Built Conservatory
- Spacious Rooms
- Generous Garden

phillips george | sales & lettings

Agents Note: Whilst every care has been taken to prepare these sales particulars, they are for guidance purposes only. All measurements are approximate and for general guidance purposes only and whilst every care has been taken to ensure their accuracy, they should not be relied upon and potential buyers are advised to recheck the measurements

🏠 46 Long Street, Wigston, Leicestershire, LE18 2AH

✉ info@phillipsgeorge.co.uk  
☎ 0116 216 8178

