



## Lon-Y-Celyn, Whitchurch

£385,000

- GARAGE
- OFF ROAD PARKING
- TWO RECEPTION ROOMS
- REAR GARDEN
- EXCELLENT LOCATION
- LOFT ROOM
- EPC Rating: D



3 2 1



## About the property

A traditional bay fronted three bedroom semi-detached property situated at the end of a cul-de-sac on an enclosed corner plot with off road parking and garage. Walking distance of public transport, schools and shops. Potential for extension subject to the necessary planning permissions.





## Accommodation

### Entrance Hall

Entered via wooden double glazed door to hall, understairs cupboard, wood block floor.

### Lounge

12' 1" maximum x 14' into bay ( 3.68m maximum x 4.27m into bay )  
Good sized lounge, wood block floor, TV point and radiator, bay window to front.

### Dining Room

13' 9" x 11' 2" maximum ( 4.19m x 3.40m maximum )  
Wood block floor, TV point, radiator, double glazed patio doors giving access to the rear.

### Kitchen

8' 2" x 9' ( 2.49m x 2.74m )  
Fully fitted kitchen with plenty of wall and base units, stainless steel sink and drainer with mixer tap, plenty of work surfaces with tiled splashbacks over, electric oven with gas hob with cooker hood, space for fridge freezer, radiator, open through to rear inner hall with wall mounted central heating boiler, radiator and access to shower area.

### Landing

Stairs to first floor, double glazed window to the front, doors to:

### Bedroom One

14' into bay x 10' 5" ( 4.27m into bay x 3.17m )  
Stairs to first floor, double glazed window to the front, doors to:

### Bedroom Two

13' x 10' 10" ( 3.96m x 3.30m )  
Built-in wardrobes, radiator, window to rear.

### Bedroom Three

8' 2" x 8' 1" ( 2.49m x 2.46m )  
Wood block floor, access to loft room, radiator, window to rear.

### Bathroom

7' 8" x 4' 6" ( 2.34m x 1.37m )  
White three-piece suite comprising free standing roll-top bath, pedestal wash hand basin, low level wc, heated towel rail, limestone floor.

02920 612328

whitchurch@peteralan.co.uk

## Floorplan

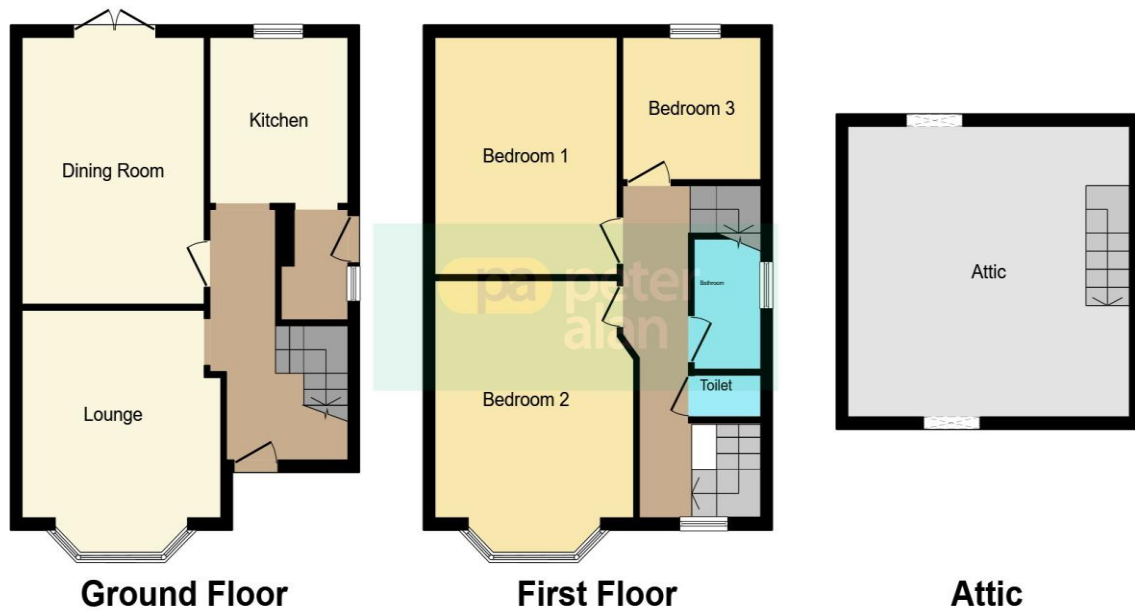

This floorplan is for illustrative purposes only and is not drawn to scale. Measurements, floor-areas, openings and orientations are approximate. They should not be relied upon for any purpose and do not form any part of an agreement. No liability is taken for any error or mis-statement. All parties must rely on their own inspections.

## Important Information

Note while we endeavour to make our sales details accurate and reliable, if there is any point which is of particular interest to you, please contact the office and we will be pleased to confirm the position for you. We have not personally tested any apparatus, equipment, fixtures, fittings or services and cannot verify they are in working order or fit for their purposes. Nothing in these particulars is intended to indicate that carpets or curtains, furnishings or fittings, electrical goods (whether wired or not). Gas fires or light fittings or any other fixtures not expressly included form part of the property offered for sale. This computer generated Floorplan, if applicable, is intended as a general guide to the layout and design of the property. It is not to scale and should not be relied upon for dimensions. Tenure: We cannot confirm the tenure of the property as we have not had access to the legal documents. The buyer is advised to obtain verification from their solicitor or surveyor.

Peter Alan Limited is registered in England and Wales under company number 2073153, Registered Office is Cumbria House, 16-20 Hockliffe Street, Leighton Buzzard, Bedfordshire, LU7 1GN. VAT Registration Number is 500 2481 05. For activities relating to regulated mortgages and non-investment insurance contracts, Peter Alan Limited is an appointed representative of Connells Limited which is authorised and regulated by the Financial Conduct Authority. Connells Limited's Financial Services Register number is 302221. Most buy-to-let