

Why use S J Smith Estate Agents? Here's some of our Google reviews to tell you why!

4.9 Stars! Google review

Hours: 8am-7pm Monday to Friday, 8am-5pm Saturday and 10am-2pm Sunday.
Phone: Ashford-01784 243 333 Staines-01784 779 100
Email: ashford@sjsmithestateagents.co.uk staines@sjsmithestateagents.co.uk



Ian Rozario
1 review



Top class team - Rob, Nicola and Chad were always on hand to ensure that the process moved forward as quickly as possible. Polite, courteous and trustworthy. Recommend highly if you are looking for a reputable Estate Agents.



Steve Widgey
1 review



An excellent service from valuation to completion. I felt under no pressure from Simon, who provided me with the valuation. We had a sensible and realistic conversation about the asking price and I appreciated the fact that he did not feel the need to enhance the asking price to gain my custom or pressure me into signing the contract, as one other agent did. I was informed about each and every viewing and always received feedback. Both Simon and Amir were a pleasure to speak to on every occasion and provided me with advice which proved valuable. Once I had accepted an offer, Nicola (the sales progression manager) was amazing. She was patient when I was not and helped with communication between all parties. I would recommend SJ Smith to anyone who is selling their property.



Katie Stevens
2 reviews



We used these guys to sell our property in ashford Middlesex. It wasn't exactly the most straight forward of sales but Louis dealt with everything, and reassured us the whole way through. IF we were ever to sell again, I would 100% choose SJ Smith to manage the sale. Massive thank you to Louis, Nicola, Chad and Rob



Chris Clark
1 review



SJ Smith were excellent, I would recommend them to anyone that would benefit from a great service. Amir was our dedicated agent and he went above and beyond in helping us sell our property and even assisted us in our purchase, that was over 100 miles away by communicating with the other estate agent we purchased from. Superb!



Sinthuja Cain
1 review



I worked with Chad, Louis and Nicola on the selling of my property in Ashford, and the purchase of a new property with them also. They are honest, decent professionals that have a lovely friendly approach and I cannot recommend them enough. I dealt with other estate agents in the area, with tough sales pitches, and sometimes forcing properties on us, but SJ Smith only contacted us with properties we would like; also they took amazing pictures of my property which really made it easy and quick to sell for a good price in this market! Thanks all! Sindy & James



24 Stewart Avenue, Shepperton TW17 0EH

£550,000 Freehold

- **HIGHLY SOUGHT AFTER LOCATION**
- **RE-FURBISHED IN 2015**
- **RE-FITTED KITCHEN WITH SIEMENS INTEGRATED APPLIANCES**
- **RE-PLACED GAS CENTRAL HEATING SYSTEM IN 2015**
- **REPLACED DOUBLE GLAZING 2015**
- **OWN DRIVEWAY**
- **NEW FLOORING THROUGHOUT**
- **RE-WIRED THROUGHOUT 2015**
- **RE-FITTED BATHROOM SUITE**
- **GARAGE**
- **1 MILE TO SHEPPERTON HIGH STREET**
- **CORNER PLOT**
- **EPC RATING BAND TBC**

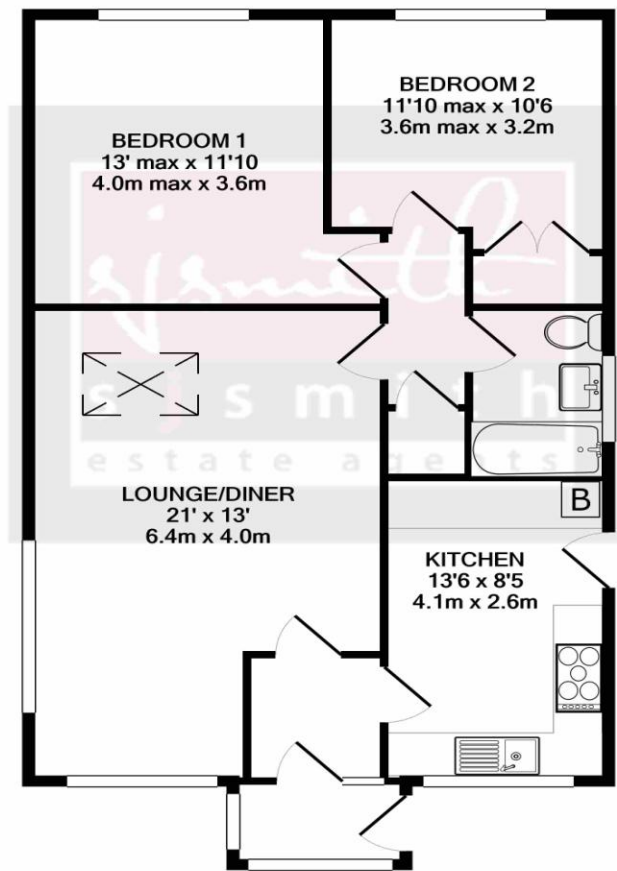
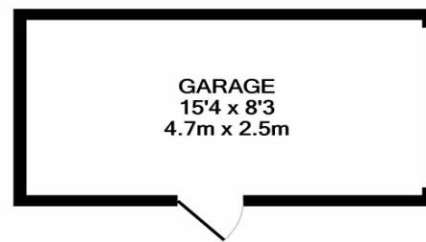

TOTAL APPROX. FLOOR AREA 892 SQ.FT. (82.9 SQ.M.)

Whilst every attempt has been made to ensure the accuracy of the floor plan contained here, measurements of doors, windows, rooms and any other items are approximate and no responsibility is taken for any error, omission, or mis-statement. This plan is for illustrative purposes only and should be used as such by any prospective purchaser. The services, systems and appliances shown have not been tested and no guarantee as to their operability or efficiency can be given
Made with Metropix ©2021

A chance to acquire this stunning detached two bedroom bungalow nestled on a corner plot in the sought after village of Shepperton, in Stewart Avenue which lies just 1 mile to the High Street and amenities. Re-furbished throughout to a high standard in 2015 by the current owners the property now boasts a number of attractive features including: an own driveway to the front, entrance porch which opens into the bright and spacious dual aspect lounge diner with recently added skylight, there is a stunning re-fitted kitchen with integrated "Siemens" appliances, a Pyrolytic oven, induction hob and attractive composite worktops. In addition to this there are two good size bedrooms, the second of which has a built-in wardrobe, and there is an attractive modern three piece bathroom suite which was also upgraded in 2015. Further improvements include: re-wiring and a new gas central heating system throughout, replaced double glazing, new carpets in the bedrooms and replaced "Karndean" flooring in the other rooms. Externally the property offers small but easily maintained side and rear gardens, a driveway to the front and a garage to the rear. There is also a large loft space which has a ladder and insulation the property is located in a pleasant leafy quiet road close to local schools, parks and Shepperton Studios. Viewings come highly recommended!

