



- TWO DOUBLE BEDROOMS
- CLOSE TO SHOPS
- CLOSE TO NORTHWOOD STATION
- PARKING

137 Thirlmere Gardens, Northwood, HA6 2RX

Asking Price Of £475,000

Situated in a premier location close to highly regarded local schools, Mount Vernon hospital and Northwood's vast array of shopping amenities and transport links. Kitchen/breakfast room, lounge, two double bedrooms, family bathroom, private garden, garage and off street parking. Early viewings advised.



Property Description

THE LOCATION

Thirlmere Gardens is situated in a central location moments away from the shops, restaurants and coffee shops of Northwood. Bulk shopping can be done at Waitrose supermarket and for the commuter the Metropolitan Line Station provides a swift and regular service to Baker Street and the City. Also close by is Mount Vernon hospital, Ruislip Lido and Rickmansworth Aqua dome.

THE PROPERTY

From the front door there is a large kitchen/breakfast room which leads to a 21ft lounge/diner with doors to the garden. To the first floor there are two double bedrooms, storage cupboards and a family bathroom. In our opinion this well appointed family home is offered to the market in good condition throughout.

OUTSIDE

To the front of the property there is a low maintenance garden with garage and parking. Outside to the rear there is an attractive landscaped garden with a range of shrubs and a patio area.

DETAILS OF SALE

Freehold sale
Hillingdon Council
Council tax band D





Approximate Gross Internal Area = 79.3 sq m / 853 sq ft
 Garage (Excluding Store) = 12.5 sq m / 134 sq ft
 Total = 91.8 sq m / 987 sq ft

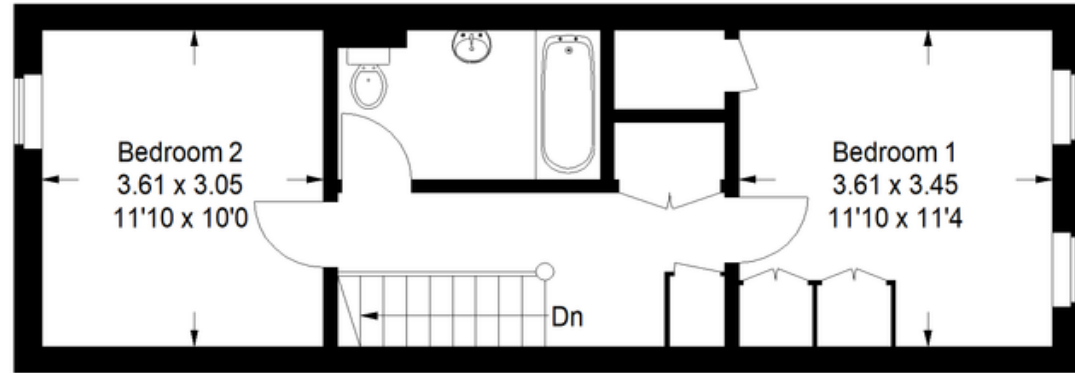

First Floor

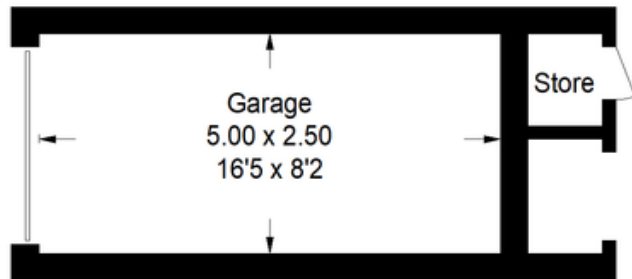

(Not Shown In Actual Location / Orientation)

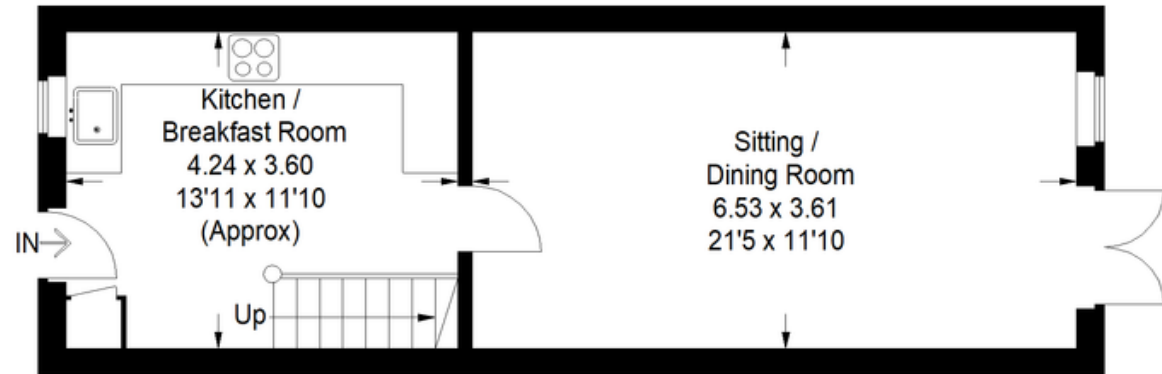

Ground Floor

Illustration for identification purposes only, measurements are approximate, not to scale.