

Pritchard's Road, E2



Located a stones throw from Broadway Market is this excellently presented and generously proportioned three bedroom contemporary apartment with residents' roof terrace. The property is set on the ground floor of a small desirable development and boasts an impressive 861sqft (80sqm) of living space. Comprising a spacious open-plan living area, three double bedrooms and two bathrooms. Other benefits include a south-west facing residents' roof terrace and BBQ space and secure bike storage. The cafés, bars and restaurants of Broadway Market plus the open green space of London Fields are on the doorstep whilst Columbia Road, Shoreditch, Haggerston Park and Victoria Park are moments away. The City is within walking distance and numerous local transport links are in easy reach. Offered to the market with no onward chain.

£625,000
Leasehold

KEY FEATURES

- Excellently presented ground floor flat.
- Stylish and contemporary development.
- Spacious open-plan living area.
- Boasting 861sqft (80sqm) of space.
- Three double bedrooms.
- Two bathrooms.
- Wrap around patio.
- Broadway Market / London Fields on the doorstep.

ENERGY PERFORMANCE CERTIFICATE

Score	Energy rating	Current	Potential
92+	A		
81-91	B		
69-80	C		78 C
55-68	D	60 D	
39-54	E		
21-38	F		
1-20	G		

ADDITIONAL INFORMATION

TENURE:	Leasehold	(Advised by Vendor)
SERVICE CHARGE:	£3,363	(Advised by Vendor)
GROUND RENT:	£250	(Advised by Vendor)
COUNCIL TAX:	D	(Advised by Vendor)
LOCAL AUTHORITY:	Hackney London Borough Council	
VIEWING:	By appointment through BlakeStanley	

For clarification, we wish to inform prospective purchasers that we have prepared these sales particulars as a general guide. We have not carried out a detailed survey, nor tested the services, appliances and specific fittings. Room sizes are approximate and believed to be accurate within 6 inches. They should not be relied upon for carpets and furnishings.











GROUND FLOOR
861 sq.ft. (80.0 sq.m.) approx.

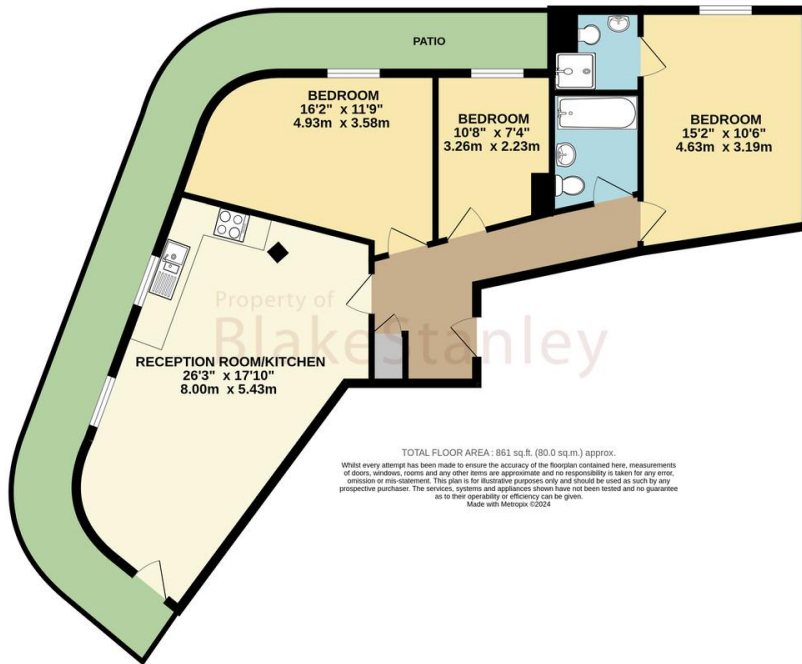

TOTAL FLOOR AREA: 861 sq.ft. (80.0 sq.m.) approx.
Whilst every attempt has been made to ensure the accuracy of the floorplan contained here, measurements of doors, windows, rooms and any other items are approximate and no responsibility is taken for any error, omission or mis-statement. This plan is for illustrative purposes only and should be used as such by any prospective purchaser. The services, systems and appliances shown have not been tested and no guarantee as to their operability or efficiency can be given.
Made with Metropix ©2004