



PAKENHAM ROAD

BIRMINGHAM, B15 2NE

£180,000
LEASEHOLD

PERFECT for 1st Time Buyers | 2 Bed, 1 Bath Maisonette in a DELIGHTFUL area of Edgbaston | Low Service Charge | Residents Parking | Easy Commute to City Centre, QE Hospital or University of Birmingham | VACANT | NO CHAIN | Viewings Ongoing, Call Davidson Estates to Book Yours!

Davidson

APPROXIMATE GROSS INTERNAL AREA: 547.3 SQ.F / 50.8 SQ.M

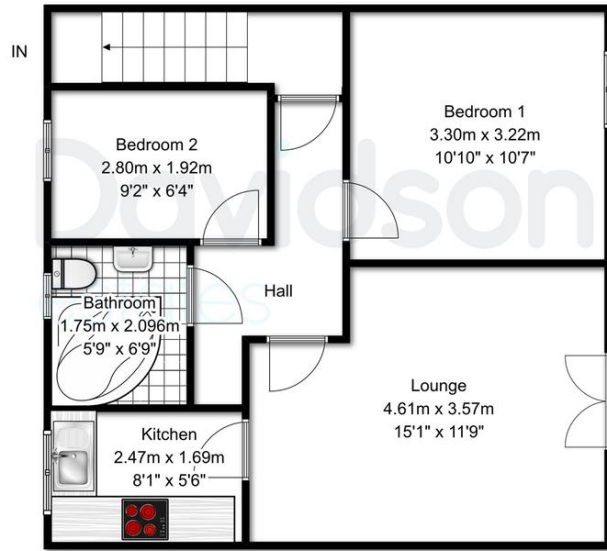

Floorplan measurements are for illustrative purpose only. Floor plan by www.sebastiano.co.uk.

Score	Energy rating	Current	Potential
92+	A		
81-91	B		
69-80	C		76 C
55-68	D		
39-54	E	49 E	
21-38	F		

Davidson

OFFICE
 14 Frederick Road
 Birmingham
 West Midlands
 B15 1JD

0121 455 7727
info@davidsonstates.co.uk
www.davidsonstates.co.uk

Agents Note: Whilst every care has been taken to prepare these particulars, they are for guidance purposes only. All measurements are approximate and are for general guidance purposes only and whilst every care has been taken to ensure their accuracy, they should not be relied upon and potential buyers/tenants are advised to recheck the measurements