



Gwladys Street, £145,000

- Council Tax Band B
- Ideal first-time buy
- Garage to the rear
- Low maintenance garden
- Set over three floors
- EPC Rating: Awaited



3 1 1



About the property

Presenting a superb opportunity for First Time Buyers, Investors and Families alike, this terraced house is located in an ideal area with excellent Public Transport Links, Nearby Schools, Local Amenities, and Walking Routes. The property boasts three bedrooms, a single garage, and a charming garden, providing an ideal space for relaxation and leisure.

The house is set over three floors, offering ample living space. On the ground floor, you will find a welcoming reception room featuring a dining area perfect for hosting family and friends. The room flows naturally into the well-appointed kitchen, which is also located on the ground floor.

The property also features a convenient bathroom on the ground floor, providing ease of access for all residents and guests. The three bedrooms are well-proportioned and offer comfortable accommodation for all occupants. The single garage is a notable feature, providing secure parking or additional storage space, depending on your needs.

With its fantastic location and unique features, this terraced house is a truly desirable property. Don't miss out on this golden opportunity to make this house your new home.



Accommodation

Hall

Lounge/Diner

21' 9" Max x 13' 5" Max (6.63m Max x 4.09m Max)

Kitchen

13' 1" Max x 8' 8" Max (3.99m Max x 2.64m Max)

Bathroom

Landing

Bedroom 1

9' 8" Max x 14' 6" Max (2.95m Max x 4.42m Max)

Bedroom 2

11' 5" Max x 10' 3" Max (3.48m Max x 3.12m Max)

Bedroom 3

11' 5" Max x 10' 3" Max (3.48m Max x 3.12m Max)

Restricted head height.

Garage

16' Max x 12' 1" Max (4.88m Max x 3.68m Max)

01685 722223

merthytydfil@peteralan.co.uk

Floorplan

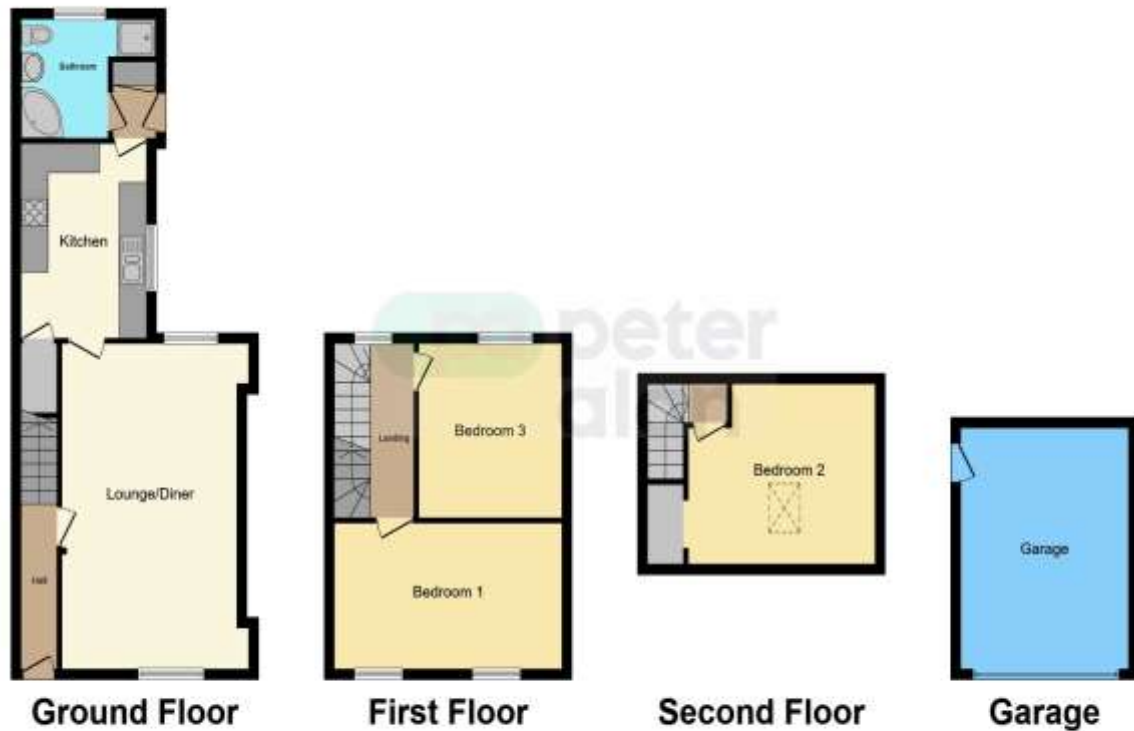

This floor plan is for illustrative purposes only. It is not drawn to scale. Any measurements, floor areas (including any total floor area), openings and orientation are approximate. No details are guaranteed, they cannot be relied upon for any purpose and they do not form part of any agreement. No liability is taken for any error, omission or misstatement. A party must rely upon its own inspection(s). Powered by www.focalagent.com

Important Information

Note while we endeavour to make our sales details accurate and reliable, if there is any point which is of particular interest to you, please contact the office and we will be pleased to confirm the position for you. We have not personally tested any apparatus, equipment, fixtures, fittings or services and cannot verify they are in working order or fit for their purposes. Nothing in these particulars is intended to indicate that carpets or curtains, furnishings or fittings, electrical goods (whether wired or not). Gas fires or light fittings or any other fixtures not expressly included form part of the property offered for sale. This computer generated Floorplan, if applicable, is intended as a general guide to the layout and design of the property. It is not to scale and should not be relied upon for dimensions. Tenure: We cannot confirm the tenure of the property as we have not had access to the legal documents. The buyer is advised to obtain verification from their solicitor or surveyor.

Peter Alan Limited is registered in England and Wales under company number 2073153, Registered Office is Cumbria House, 16-20 Hockliffe Street, Leighton Buzzard, Bedfordshire, LU7 1GN. VAT Registration Number is 500 2481 05. For activities relating to regulated mortgages and non-investment insurance contracts, Peter Alan Limited is an appointed representative of Connells Limited which is authorised and regulated by the Financial Conduct Authority. Connells Limited's Financial Services Register number is 302221. Most buy-to-let

pa peter
alan