



14 Trinity Road, N22 8LB

£455,000 LEASEHOLD

This beautifully presented three-bedroom flat enjoys an enviable first-floor position with picturesque views over Trinity Gardens. Stylish and well-maintained throughout, the property features a bright open-plan lounge with a fully fitted kitchen, three well-proportioned bedrooms, and a modern bathroom. Ideally located for excellent transport links, it's just a short walk from both Wood Green Underground and Alexandra Palace railway stations, offering easy access into Central London. Perfect for first-time buyers, professionals, or investors seeking a well-connected home in a sought-after location

T: 0208 365 8900 E: boundsgreen@wilkinsonbyrne.com W: www.wilkinsonbyrne.com



The Property Misdescriptions Act 1991: None of the statements contained in these particulars as to this property are to be relied on as statements of representations of fact. Wilkinson Byrne has no tested any equipment, fixtures or fittings or services and so cannot confirm that they are in working order. Wilkinson Byrne have not sight of the title documents and any reference to the tenure of the property is based on information supplied by the seller. Wilkinson Byrne are unable to confirm that the relevant Planning Permission and/or Building Regulation Approval has been obtained where any structural alterations have occurred. A buyer is advised to obtain verification from their solicitor or surveyor of any of the above or any other fact prior to making an offer. Photographs are provided for illustration purposes only and do not depict what is included in the sale. All measurements are taken using a sonic tape, are approximate and for guidance only.





These particulars, whilst believed to be accurate set out as a general outline only for guidance and do not constitute any part of an offer or contract. Intending purchasers should not rely on them as fittings. Room sizes should not be relied upon for carpets and furnishings. The measurements given are approximate. No person in this firm's employment has the authority to make or give any representation or warranty in respect of the property.

RECEPTION ROOM/KITCHEN
21'8 x 13'1
6.61m x 3.99m

BEDROOM (2)
12'4 x 7'10
3.76m x 2.39m

MASTER BEDROOM
13'1 x 10'4
3.99m x 3.15m

BEDROOM (3)
8'4 x 8'3
2.54m x 2.52m

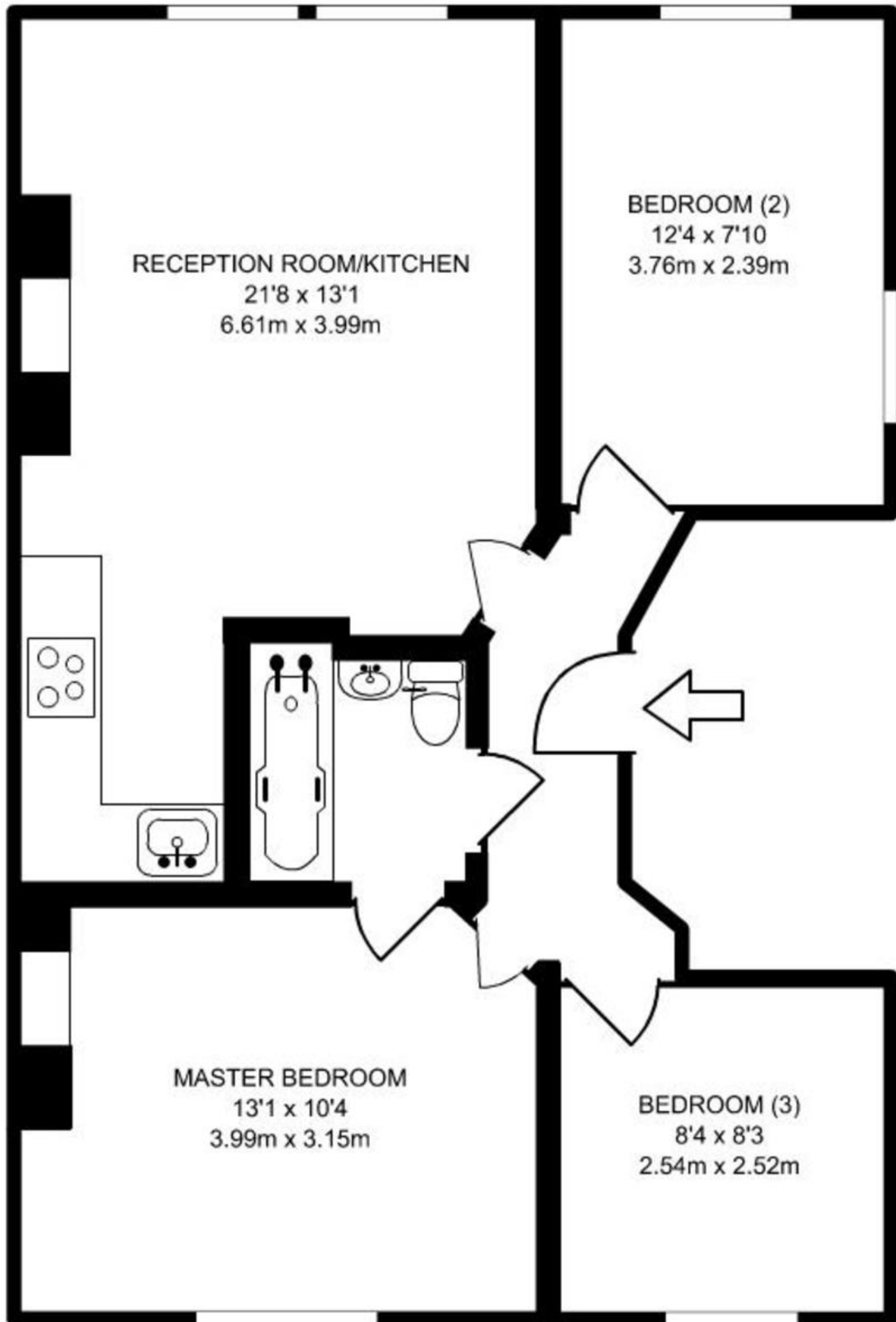

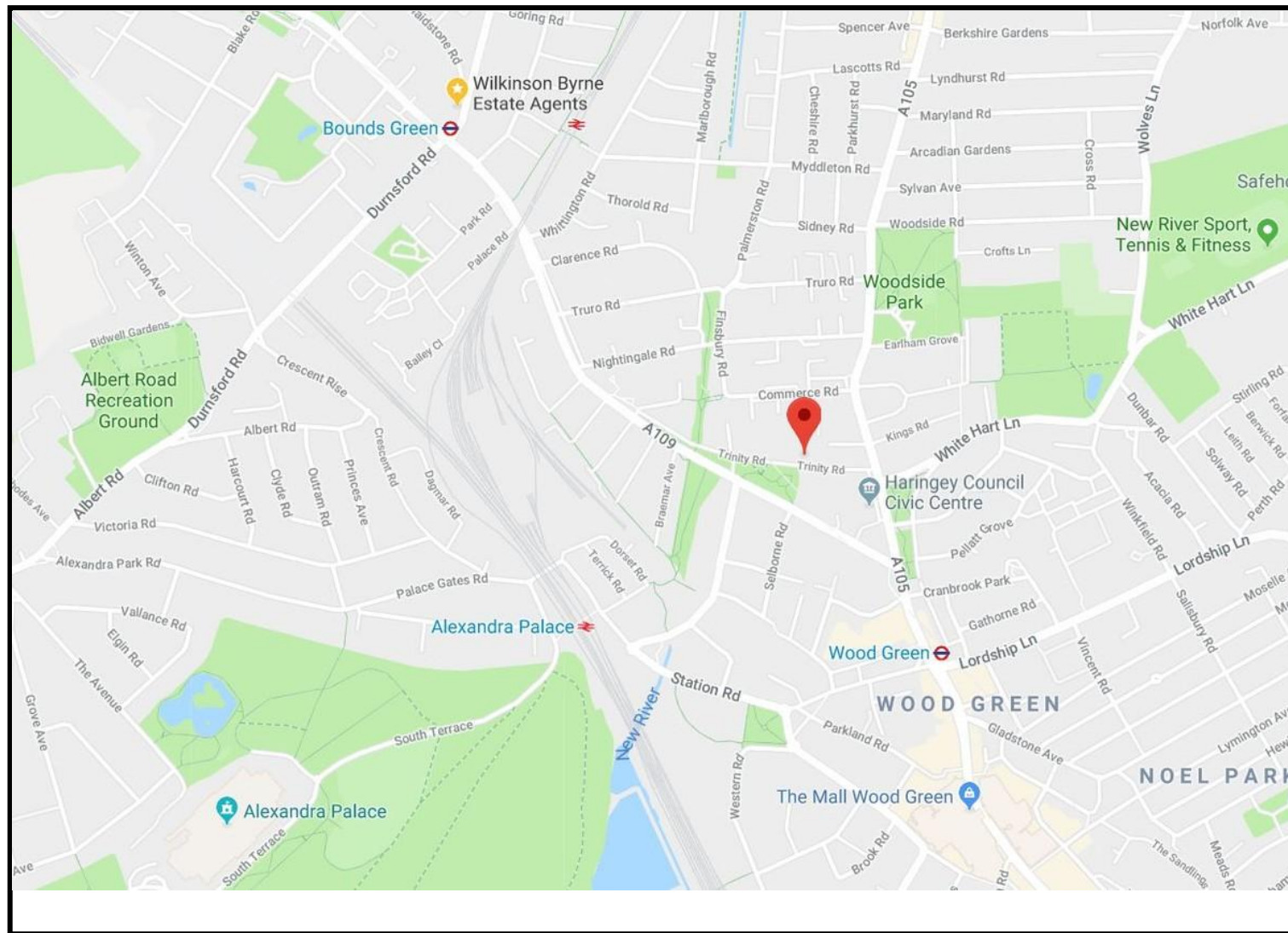

Score	Energy rating	Current	Potential
92+	A		
81-91	B	82 B	82 B
69-80	C		
55-68	D		
39-54	E		
21-38	F		
1-20	G		

Bounds Green Office
 3 Latham Court
 Brownlow Road
 London N11 2ES
 0208 - 365 - 8900
boundsgreen@wilkinsonbyrne.com

Turnpike Lane Office
 8 Turnpike Parade
 Green Lanes
 London N15 3EA
 0208 - 888 - 0022
turnpikelane@wilkinsonbyrne.com