



Eddison Court, Sussex Wa

2 Bedroom

£445,000 Guide Price
Leasehold

London, Archway





Flat 8, 253 Eddison Court, Sussex Way

Description

- 2-Bedroom Apartment
- Upper Holloway & Archway Station withi
- Communal Roof Terrace
- Double-Glazed Windows
- Three-Piece Bathroom Suite
- Energy Rating : C
- Private & Gated Entrance
- Vacant Possession & Chain Free
- Gas Central Heating
- Allocated Parking
- Light-Filled Reception Room
- Council Tax Band D

Nestled within the gated and well-maintained Eddison Court on Sussex Way, this bright and well-presented two-bedroom apartment offers comfortable and modern living in a highly convenient location.

The property comprises two generously sized bedrooms, a spacious and light-filled reception room which flows seamlessly into a newly renovated kitchen, and a contemporary three-piece bathroom suite.

Further benefits include a communal roof terrace with far-reaching views, a newly installed boiler, gas central heating, double-glazed windows, allocated parking, and a long lease with 973 unexpired years remaining.

Local transport links include Upper Holloway Overground Station and Archway Underground Station (Northern Line), both a short walk away, providing swift connections into the City and West End.

Several local bus routes run nearby and Holloway Road offers a vibrant mix of independent shops, cafés and amenities.

Green spaces of Whittington Park and Hampstead Heath are easily accessible.

Offered with vacant possession and no onward chain.

Contact Ariston Property to arrange a viewing.



Accommodation Comprises:



Lease : 972 years
Service Fees : £4000

Sussex Way, N19 4DW

Approx Gross Internal Area = 57.71 sq m / 621 sq ft

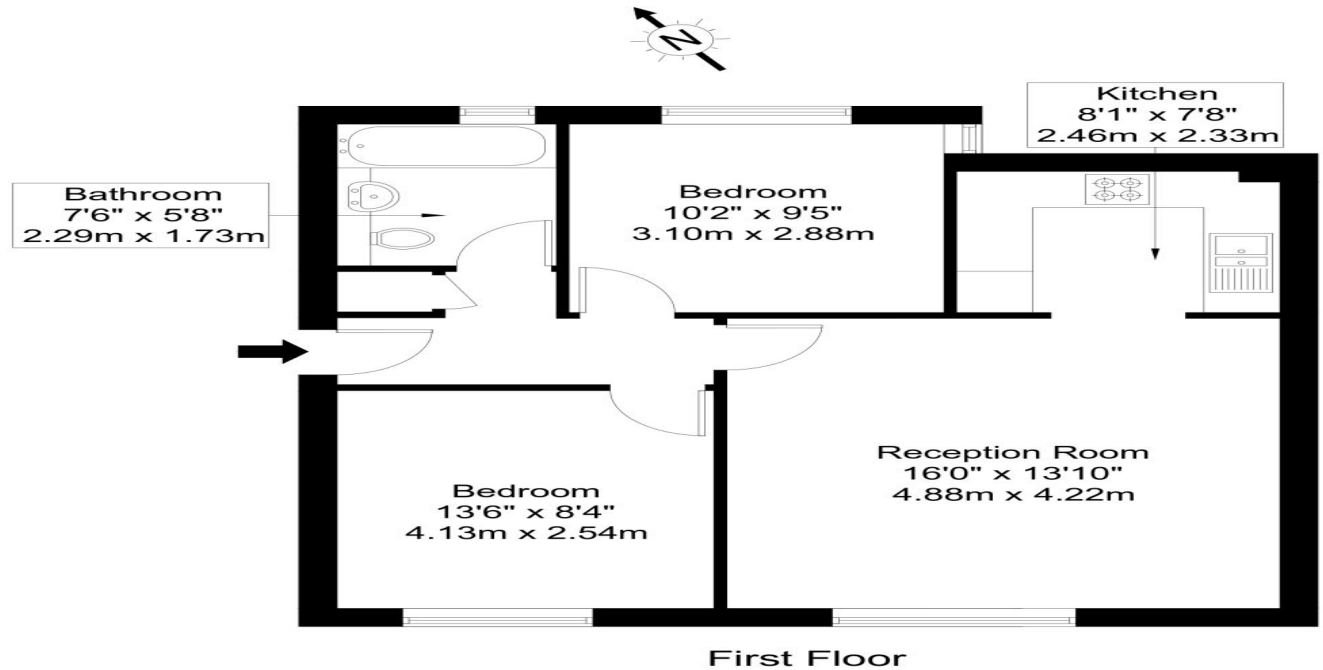

Ref :

Copyright **B L E U**
P L A N

The Floor plan is not to scale and measurements and areas shown are approximate and therefore should be used for illustrative purposes only. The plan has been prepared in accordance with the RICS code of Measuring Practice and whilst we have confidence in the information produced it must not be relied on. Maximum lengths and widths are represented on the floor plan. If there is any aspect of particular importance, you should carry out or commission your own inspection of the property.
Copyright @ BleuPlan

Certificate Number : 0755-3040-2208-2644-6204

Score	Energy rating	Current	Potential
92+	A		
81-91	B		83
69-80	C	75	
55-68	D		
39-54	E		
21-38	F		
1-20	G		

<https://find-energy-certificate.digital.communities.gov.uk/energy-certificate/0755-3040-2208-2644-6204>



528-530 Hornsey Road, Archway
London, N19 3QN

telephone : 020 7272 9988

email : info@aristonproperty.co.uk

aristonproperty.co.uk

THE PROPERTY MISDESCRIPTIONS ACT 1991: Any areas, measurements or distances are approximate. Land measurements are provided by the vendor and buyers are advised to obtain verification from their solicitor. The text, photographs and plans are for guidance only and are not necessarily comprehensive. Items shown in the property photographs are not included unless specifically mentioned within the sales particulars although they may be available by separate negotiation. Ariston Property cannot verify that the fixtures and fittings, equipment or services are in working order or fit for the purpose and buyers are advised to obtain verification from their solicitor. The tenure of a property is based upon information supplied by the seller and buyers are advised to obtain verification from their solicitor.